

DOTEST, S.L.

ROBOTICS

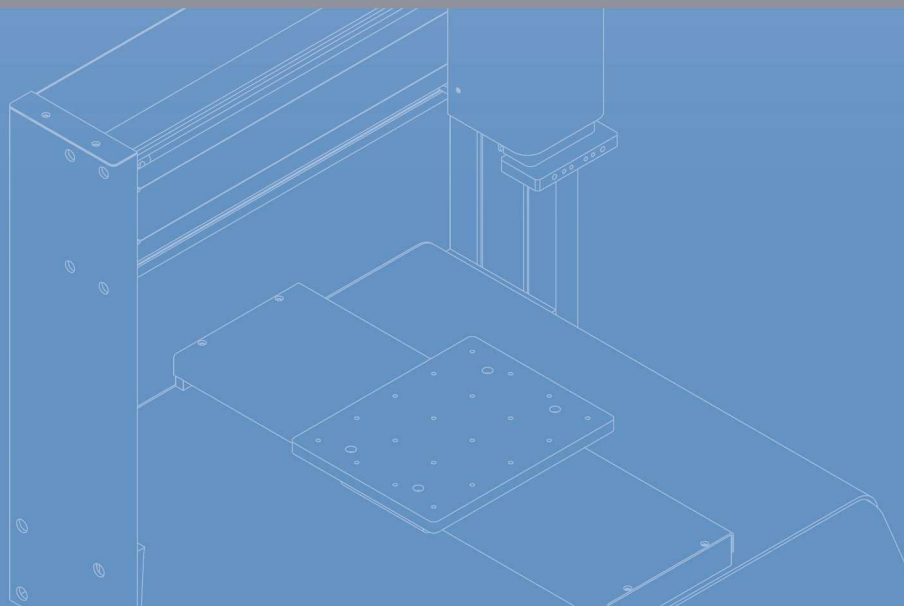

F7300N - 3 & 4 Axes

Working Area 300 x 300mm

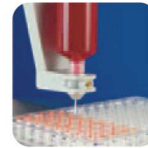

Features

- Ideal for form-in-place gaskets, adhesives, potting, coating and filling
- High Resolution 0.001mm
- Performs continuous path and point-to-point motions
- Quick fluid-purge button located on front panel
- Software tip alignment routine for quick program offsets when changing dispensing tips
- Step-and-repeat functions – program one object only for multiple identical objects
- On board 100 programs, 5 million point memory capacity, 50,000 points per program
- USB connector allows system updates and program interchange between robots
- Available without Teach Pendant for multiple installations.

The model F7300N is a RoHS compliant upgrade to the popular 11.81" x 11.81" (300 x 300mm) benchtop robot. This internationally accepted robot maintains the compact style and functionality of design, providing a precision multiple axis robot ideal for many bench dispensing projects. Resolution is 1 micron and interpolation is in all axes. The F7300N has been engineered to accept a tool weight of up to 5kg and a worktable load of 10kg, making the system tough enough for a wide range of automated dispensing applications.

Dimensions

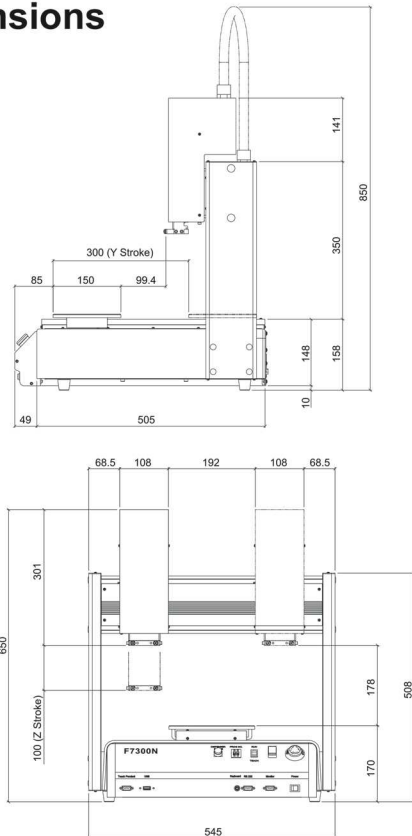

Model

F7300N

Robot 3-axes 110/220V

F7304N

Robot 4-axes 110/220V

Accessories (optional)

562008C

External start box

DSP501LF

Dispenser

F7000N-WIN

Windows® software package

Specifications

| | |
|------------------------------|---|
| X/Y/Z Work area (mm): | 300 / 300 / 100 4th axis +/-360° |
| Worktable load / Tool: | 10 kg. / 5 kg. |
| Max. Speed X&Y / Z: | 800 / 320 (mm/sec) |
| Repeatability: | +/- 0.02mm/ Axis |
| Resolution: | 0.001mm/ Axis |
| Data Memory: | 100 Programs 50,000 points / program |
| Processor: | 32 Bit |
| Drive Sys. / Stepping motor: | 5-phase micro stepping motor |
| Motion Control: | PTP & CP |
| Teaching Method: | Teach Pendant |
| I/O signals: | 8 inputs / 8 outputs |
| External Interface: | USB / RS232 |
| Power Supply: | Auto-switching AC100-240 - 300 Watts |
| Dimensions (WxDxH): | 545 x 554 x 850 |
| Weight: | 82.5 lbs (37.5 kg) |

F7400N - 3 & 4 Axes

Working Area 400 x 400mm

Optima

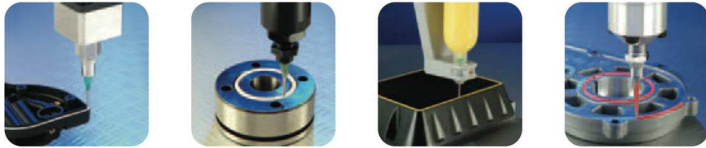

Features

- Ideal for form-in-place gaskets, adhesives, potting, coating and filling
- High Resolution 0.001mm
- Performs continuous path and point-to-point motions.
- Quick fluid-purge button located on front panel
- Software tip alignment routine for quick program offsets when changing dispensing tips
- Step-and-repeat functions – program one object only for multiple identical objects
- On board 100 programs, 5 million point memory capacity, 50,000 points per program
- USB connector allows system updates and program interchange between robots
- Available without Teach Pendant for multiple installations



The model F7400N dispensing robot has the largest working area in the F7000N series at 15.75" x 15.75" (400 x 400mm). Fisnar Inc. robots interpolate in all axes for 3D dispensing of adhesives, silicones and UV Cure resins. It is also possible to mount a vacuum pick and place system coupled with automatic dispensing equipment for dispense and place operations. Resolution is 1 micron and interpolation is in all axes. The F7400N has been engineered to accept a tool weight of up to 5kg and a worktable load of 10kg, making the system tough enough for a wide range of automated dispensing applications.

Model

| | |
|--------|-----------------------|
| F7400N | Robot 3-axes 110/220V |
| F7404N | Robot 4-axes 110/220V |

Accessories (optional)

| | |
|------------|---------------------------|
| 562008C | External start box |
| DSP501LF | Dispenser |
| F7000N-WIN | Windows® software package |

Specifications

| | |
|------------------------------|---|
| X/Y/Z Work area (mm): | 400 / 400 / 100 4th axis +/-360° |
| Worktable load / Tool: | 10 kg. / 5 kg. |
| Max. Speed X&Y / Z: | 800 / 320 (mm/sec) |
| Repeatability: | +/- 0.02mm/ Axis |
| Resolution: | 0.001mm/ Axis |
| Data Memory: | 100 Programs 50,000 points / program |
| Processor: | 32 Bit |
| Drive Sys. / Stepping motor: | 5-phase micro stepping motor |
| Motion Control: | PTP & CP |
| Teaching Method: | Teach Pendant |
| I/O signals: | 8 inputs / 8 outputs |
| External Interface: | USB / RS232 |
| Power Supply: | Auto-switching AC100-240 - 300 Watts |
| Dimensions (WxDxH): | 635 x 645 x 850 |
| Weight: | 94.6 lbs (43 kg) |

Dimensions

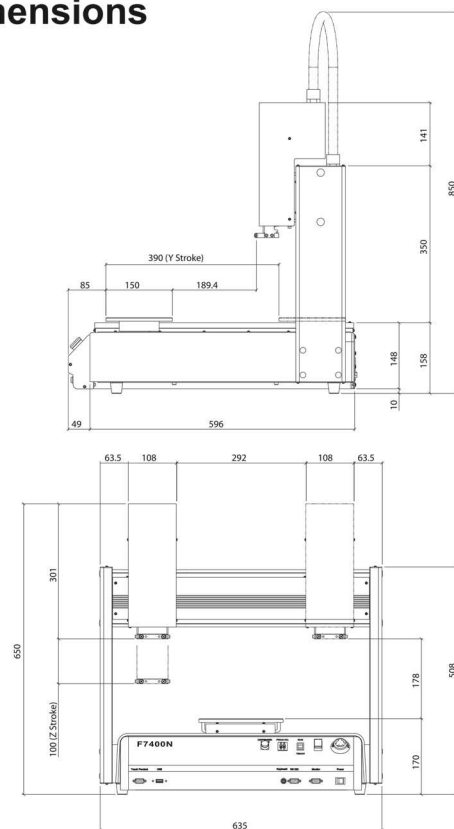

F7000NV - Series Vision System

With Auto Alignment Function

Features

- Ideal for irregular dispensing route per component
- High Resolution 0.001mm
- Automatic offset of dispensing route
- Precision operation
- Increased production efficiency
- Touch screen programming
- Preview simulation of dispense route
- Auto offset of coordinates after tip change
- Edit programs directly - easy learn - fast response
- CAD DXF and Excel accepted
- Optional LED light accessories for light conditions



Model (complete system)

| | |
|---------|------------------------------------|
| F7300NV | 3-axes Robot 300x300mm 110/220V CE |
| F7400NV | 3-axes Robot 400x400mm 110/220V CE |

Accessories (optional)

| | |
|----------|--------------|
| F7001NZ | 4X zoom lens |
| DSP501LF | Dispenser |



Detail

Touch screen programming with simulation preview.

Vision system includes:

- Robot 3 axes - optional 300 x 300mm or 400 x 400mm
- Touch screen PC
- Software
- Color camera
- Camera control
- Exlite Cognate in-sight white LED
- CCD conversion ring (20.40.60mm)
- CCD fixture, LSC light fixture, control system fixture
- Frame capture dongle USB, extended line, LAN cable

The vision system is supplied complete including the PC, ensuring all components are compatible, thereby eliminating any costly start-up issues and reducing the learning curve.

The system is designed to provide automatic dispensing program offsets when the dispensing path of a component cannot be guaranteed.

Accepts CAD, DXF and Excel formats for dispense paths. Commonly two fiducial points are used to provide program offsets, however one is also possible.

Optional LED's may be required depending on refractive surface.



Specifications

| | |
|-----------------------|--|
| X/Y/Z Work area (mm): | 300 / 300 / 100 or 400 / 400 / 100 |
| Vision Software: | Robot Vision |
| System Operation: | Touch Screen Computer (All in One) |
| Camera: | USB Color Camera |
| Interface Port: | LAN |
| Frame Grabber: | USB Dongle |
| Light System: | EXLITE Cognate In-Sight White LED |
| Lens: | 4X (optional) |
| Teaching Method: | 1. PC Software, 2. Screen Touch, 3. Teach Pendant |
| Software Function: | 1. Program Edit, 2. Auto Vision Align, 3. Accept DXF Files |

F4300N - 3 Axes

Working Area 300 x 300mm



Features

- High resolution 0.001mm
- On board 100 programs, 400,000 point memory capacity, 4,000 points per program
- Performs continuous path and point-to-point motions
- Quick fluid-purge button located on front panel
- Software tip alignment routine for quick program offsets when changing dispensing tips
- Step-and-repeat functions – program one object only for multiple identical objects
- Ideal for form-in-place gaskets, adhesives, potting, coating and filling
- Available without Teach Pendant for multiple installations
- USB connector allows system updates and program interchange between robots

A powerful compact-sized desktop robot with a working area of 11.81" x 11.81" (300 x 300mm). Its reduced benchtop footprint makes it an ideal robot for automating a current manual dispensing application. Programming is carried out by a teach-pendant (included) using the industry's leading dispensing software that walks the user through step-by-step instructions to create a sophisticated dispensing operation in minutes.

Dimensions

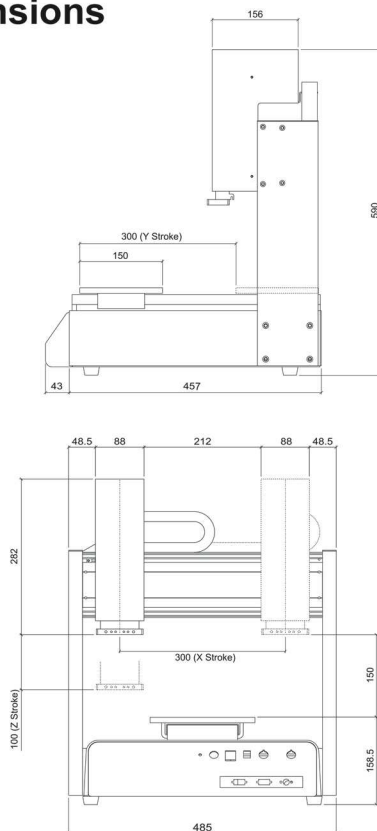

Model

F4300N

Robot 3-axes 110/220V

Accessories (optional)

562008C

External start box

DSP501LF

Dispenser

F4000N-WIN

Windows® software package

Specifications

| | |
|------------------------------|--|
| X/Y/Z Work area (mm): | 300 / 300 / 100 |
| Worktable load / Tool: | 10 kg. / 5 kg. |
| Max. Speed X&Y / Z: | 800 / 320 (mm/sec) |
| Repeatability: | +/- 0.02mm/ Axis |
| Resolution: | 0.001mm/ Axis |
| Data Memory: | 100 Programs 4,000 points / program |
| Drive Sys. / Stepping motor: | 3-phase |
| Motion Control: | PTP & CP |
| Teaching Method: | Teach Pendant |
| I/O signals: | 8 inputs / 8 outputs |
| External Interface: | USB / RS232 |
| Power Supply: | AC 95-132V, AC 180-250V |
| Dimensions (WxDxH): | 485 x 500 x 590 |
| Weight: | 66 lbs (30 kg) |

F4400N - 3 Axes

Working Area 400 x 400mm

Plus

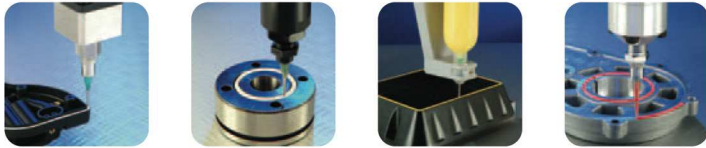

Features

- Ideal for form-in-place gaskets, adhesives, potting, coating and filling
- High resolution 0.001mm
- Performs continuous path and point-to-point motions
- Quick fluid-purge button located on front panel
- Software tip alignment routine for quick program offsets when changing dispensing tips
- Step-and-repeat functions – program one object only for multiple identical objects
- On board 100 programs, 400,000 point memory capacity, 4,000 points per program
- Available without Teach Pendant for multiple installations
- USB connector allows system updates and program interchange between robots



The model F4400N provides a generous working area of 15.75" x 15.75" (400 x 400mm). Fisnar robots interpolate in all axes for 3D dispensing of adhesives, silicones and UV Cure resins.

Resolution is 1 micron and interpolation is in all axes. The F4400N has been engineered to accept a tool weight of up to 5kg and a worktable load of 10kg, making the system tough enough for a wide range of automated dispensing applications.

Model

F4400N Robot 3-axes 110/220V

Accessories (optional)

562008C External start box
 DSP501LF Dispenser
 F4000N-WIN Windows® software package

Specifications

| | |
|------------------------------|--|
| X/Y/Z Work area (mm): | 400 / 400 / 100 |
| Worktable load / Tool: | 10 kg. / 5 kg. |
| Max. Speed X&Y / Z: | 800 / 320 (mm/sec) |
| Repeatability: | +/- 0.02mm/ Axis |
| Resolution: | 0.001mm/ Axis |
| Data Memory: | 100 Programs 4,000 points / program |
| Drive Sys. / Stepping motor: | 3-phase |
| Motion Control: | PTP & CP |
| Teaching Method: | Teach Pendant |
| I/O signals: | 8 inputs / 8 outputs |
| External Interface: | USB / RS232 |
| Power Supply: | AC 95-132V, AC 180-250V |
| Dimensions (WxDxH): | 530 x 600 x 596 |
| Weight: | 88 lbs (40 kg) |

Dimensions

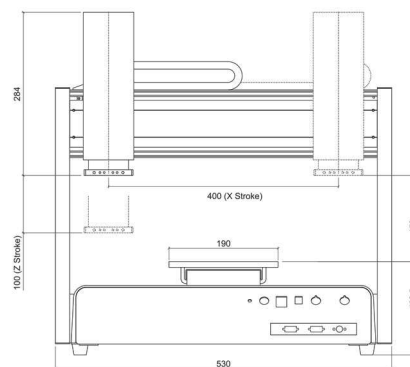
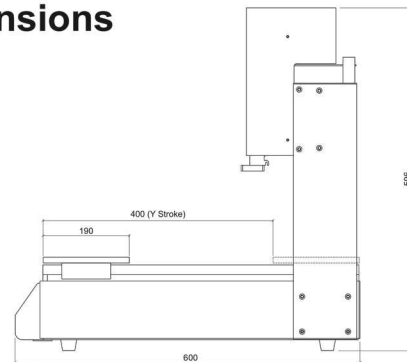

(973) 646-5044

F4500N - 3 Axes

Working Area 500 x 500mm



Features

- High resolution 0.001mm
- On board 100 programs, 400,000 point memory capacity, 4,000 points per program
- Performs continuous path and point-to-point motions
- Quick fluid-purge button located on front panel
- Software tip alignment routine for quick program offsets when changing dispensing tips
- Step-and-repeat functions - program one object only for multiple identical objects
- Ideal for form-in-place gaskets, adhesives, potting, coating and filling
- Available without Teach Pendant for multiple installations
- USB connector allows system updates and program interchange between robots

A powerful and optimum sized benchtop robot with a working area of 19.68" x 19.68" (500 x 500mm) and extra Z reach of 5.90" (150mm). Ideal for large non contiguous structures and for larger dispensing equipment or apparatus. The F4500N is suitable for plasma treatment applications prior to dispensing. Programming is carried out by a teach-pendant (included) using the industry's leading dispensing software that walks the user through step-by-step instructions to create a sophisticated dispensing operation in minutes.

Dimensions

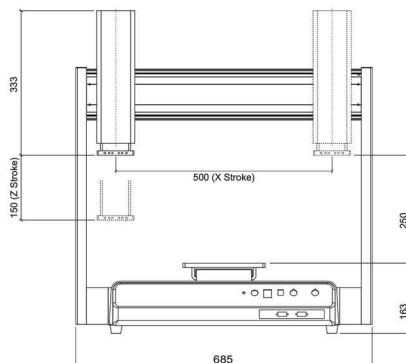
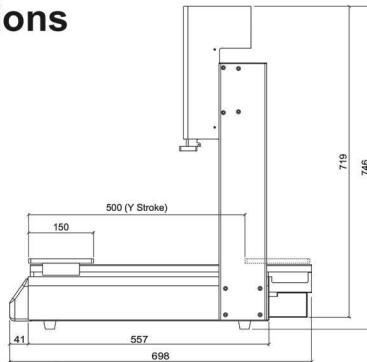

Model

F4500N

Robot 3-axes 110/220V CE

Accessories (optional)

562008C

External start box

DSP501LF

Dispenser

F4000N-WIN

Windows® software package

Specifications

| | |
|------------------------------|--|
| X/Y/Z Work area (mm): | 500 / 500 / 150 |
| Worktable load / Tool: | 10 kg. / 5 kg. |
| Max. Speed X&Y / Z: | 800 / 320 (mm/sec) |
| Repeatability: | +/- 0.02mm/ Axis |
| Resolution: | 0.001mm/ Axis |
| Data Memory: | 100 Programs 4,000 points / program |
| Drive Sys. / Stepping motor: | 3-phase |
| Motion Control: | PTP & CP |
| Teaching Method: | Teach Pendant |
| I/O signals: | 8 inputs / 8 outputs |
| External Interface: | USB / RS232 |
| Power Supply: | AC 95-132V, AC 180-250V |
| Dimensions (WxDxH): | 685 x 698 x 746 |
| Weight: | 102 lbs (46 kg) |

F4200N - 3 Axes

Working Area 200 x 200mm

Plus

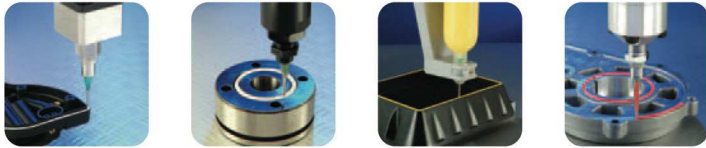

Features

- Ideal for form-in-place gaskets, adhesives, potting, coating and filling
- High resolution 0.001mm
- Performs continuous path and point-to-point motions
- Quick fluid-purge button located on front panel
- Software tip alignment routine for quick program offsets when changing dispensing tips
- Step-and-repeat functions – program one object only for multiple identical objects
- On board 100 programs, 400,000 point memory capacity, 4,000 points per program
- Available without Teach Pendant for multiple installations



The F4200N is a compact and economically priced benchtop robot. Designed for medical and laboratory type environments requiring a streamlined and easily maintained machine. This robot will support most light dispensing applications that require a high performance standard. The bench space reduction is an additional benefit. Programming is simply carried out by a teach-pendant (included) using the industry's leading dispensing software that walks the user through step-by-step instructions to create a sophisticated dispensing operation in minutes.

Model

F4200N Robot 3-axes 200x200mm 110/220V

Accessories (optional)

| | |
|------------|---------------------------|
| 562008C | External start box |
| DSP501LF | Dispenser |
| F4000N-WIN | Windows® software package |

Specifications

| | |
|------------------------------|--|
| X/Y/Z Work area (mm): | 200 / 200 / 50 |
| Worktable load / Tool: | 3 kg. / 1 kg. |
| Max. Speed X&Y / Z: | 500 / 200 (mm/sec) |
| Repeatability: | +/- 0.02mm/ Axis |
| Resolution: | 0.001mm/ Axis |
| Data Memory: | 100 Programs 4,000 points / program |
| Drive Sys. / Stepping motor: | 3-phase micro stepping motor |
| Motion Control: | PTP & CP |
| Teaching Method: | Teach Pendant |
| I/O signals: | 8 inputs / 8 outputs |
| External Interface: | USB / RS232 |
| Power Supply: | AC 95-132V, AC 180-250V |
| Dimensions (WxDxH): | 327 x 500 x 450 |
| Weight: | 33 lbs (14.9 kg) |

Dimensions

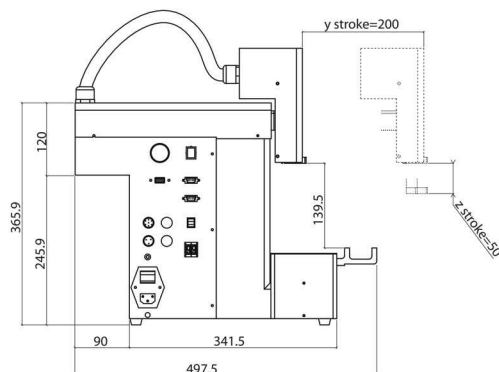
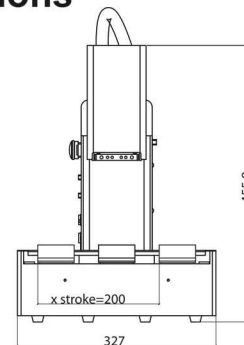

(973) 646-5044

F5200N - 3 Axes Gantry UNITOP™

Working Area 200 x 200mm



Features

- Ideal for form-in-place gaskets, adhesives, potting, coating and filling
- Place-anywhere UNITOP™ gantry design, allows flexible operation
- High resolution 0.001mm
- Performs continuous path and point-to-point motions
- Quick fluid-purge button located on front panel of controller
- Software tip alignment routine for quick program offsets when changing dispensing tips
- Step-and-repeat functions - program one object only for multiple identical objects
- On board 100 programs, 400,000 point memory capacity, 4,000 points per program
- Available without Teach Pendant for multiple installations
- USB connector allows system updates and program interchange between robots

The model F5200N is a compact and economically priced gantry robot with all moving axes above the workpiece. The Unitop™ is suitable for any platform requiring a gantry type mounting providing open access under the robot. The F5200N is also ideal for conveyor fed automation or installed in work cells operating as a slave robot.

Working area is 7.87" x 7.87" (200 x 200mm). Programming is simply carried out by a teach-pendant (included) using the industry's leading dispensing software that walks the user through step-by-step instructions to create a sophisticated dispensing operation in minutes.

Dimensions

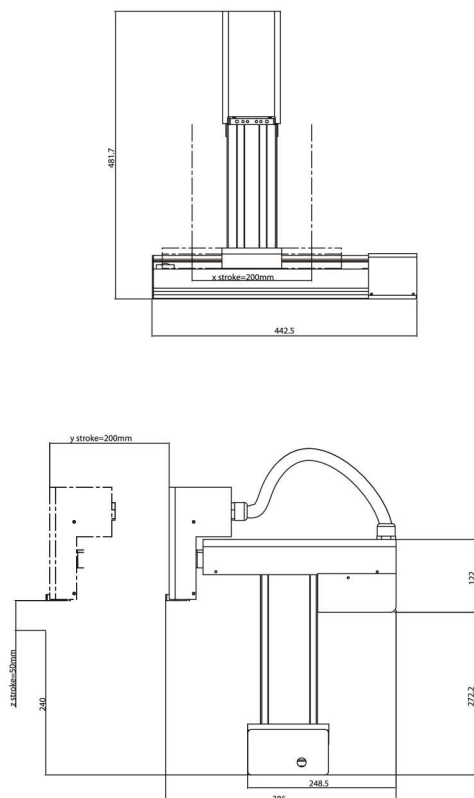

Model

F5200N

Robot UNITOP™ 3-axes 110/220V CE

Accessories (optional)

DSP501LF

Dispenser

F4000N-WIN

Windows® software package

Specifications

| | |
|------------------------------|--|
| X/Y/Z Work area (mm): | 200 / 200 / 50 |
| Total load - Z axis: | 2 kg. |
| Max. Speed X&Y / Z: | 500 / 300 (mm/sec) |
| Repeatability: | +/- 0.02mm/ Axis |
| Resolution: | 0.001mm/ Axis |
| Data Memory: | 100 Programs 4,000 points / program |
| Drive Sys. / Stepping motor: | Micro stepping motor |
| Motion Control: | PTP & CP |
| Teaching Method: | Teach Pendant |
| I/O signals: | 8 inputs / 8 outputs |
| External Interface: | USB / RS232 |
| Power Supply: | AC 110 - 220V |
| Dimensions (WxDxH): | 350 x 330 x 475 |
| Weight: | 37.4 lbs (17 kg) |

F9600N - 3 & 4 Axes Servo Gantry

Working Area 600 x 600mm



Features

- Customized sizes available
- Robust ball-screw servo motor drives
- Ideal for form-in-place gaskets, adhesives, potting, solar junctions, stringers, coating, frame sealing and filling
- Resolution 0.001mm
- Performs continuous path and point-to-point motions
- Self contained controller functions
- Software tip alignment routine for quick program offsets when changing dispensing tips
- Step-and-repeat functions – program one object only for multiple identical objects
- On board 100 programs, 3,000 points per program
- Optional bar code scanning software

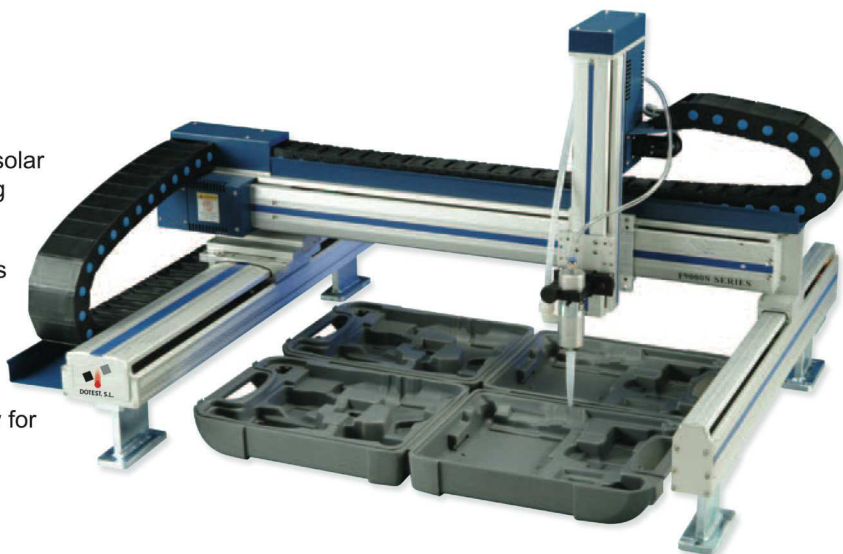

The model F9600N is a RoHS compliant 23.62" x 23.62" (600 x 600mm) gantry style robot. It's servo motor driven ball-screw design enables closed loop operation. A rugged aluminum structure helps prevent vibration while maintaining a compact style and functionality, providing a precision multiple axis robot ideal for conveyor fed applications, such as solar modules. Many projects also require all moving axes to be above the work station, the F9600N provides that capability. Resolution is 1 micron and interpolation is in all axes. The F9600N has been engineered to accept a tool weight of up to 7kg and 4kg for the 4-axes model.

Model

| | |
|--------|-------------------|
| F9600N | Robot 3-axes 220V |
| F9604N | Robot 4-axes 220V |

Accessories (optional)

| | |
|------------|---------------------------|
| DSP501LF | Dispenser |
| F9000N-WIN | Windows® software package |

Mounting Supports (two required each side)

| Main (Left Side) | Idle (Right Side) | Height | Qty |
|------------------|-------------------|--------|-----|
| 562022-050 | 562023-050 | 50mm | 1 |
| 562022-100 | 562023-100 | 100mm | 1 |
| 562022-150 | 562023-150 | 150mm | 1 |

Specifications

| | | |
|-----------------------|---|-----------------|
| X/Y/Z Work area (mm): | 600 / 600 / 200 | R-axis +/-360° |
| Maximum tool load: | 7 kg. | R-axis 4 kg. |
| Max. Speed X&Y / Z: | 1000 / 1000 / 500 (mm/sec) | R-axis 360°/sec |
| Repeatability: | +/- 0.02mm/ Axis | R-axis ± 0.05° |
| Resolution: | 0.001mm | R-axis ± 0.001° |
| Data Memory: | 100 Programs 3,000 step / PGM | |
| Processor: | Main: 32bit, 900 mflops | |
| Drive Sys. / Servo: | 3Ø AC Servo Motor 16Bit, 40mips | |
| Motion Control: | PTP & CP (3D Line, circle) | |
| Teaching Method: | Teach Pendant | |
| I/O Signals: | System I/O IN: 24, Out: 6 User I/O IN: 32, Out: 32 | |
| External Interface: | RS232 | |
| Power Supply: | 2Ø AC220V - 500VA (600VA) | |
| Dimensions (WxDxH): | 979 x 1022 x 505 | |
| Weight: | 81.4 lbs (37 kg) | |

Dimensions

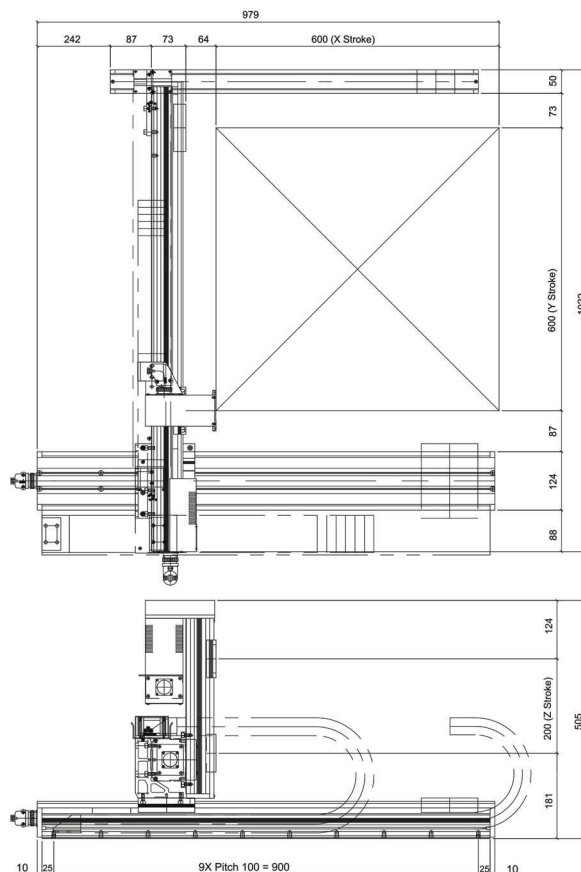

(973) 646-5044

F8800N - 3 & 4 Axes Servo Cantilever

Working Area 800 x 600mm



Features

- Compact open access design
- Highly rigid frame structure
- Ideal for form-in-place gaskets, adhesives, potting, coating and filling
- Positioning repeatability 0.02mm
- Performs continuous path and point-to-point motions
- AC servo motors and ball-screw design
- Software tip alignment routine for quick program offsets when changing dispensing tips
- Step-and-repeat functions – program one object only for multiple identical objects
- On board 100 programs, 1,000 points per program
- Memory capacity, 20,000 steps / 20,000 points



The model F8800N is a RoHS compliant 31.50" x 23.62" (800 x 600mm) cantilever open access style robot. It's servo motor driven ball-screw design enables closed loop operation. A specially ruggedized aluminum structure prevents flexing and vibration while maintaining functionality, providing a precision multiple axis robot ideal for conveyor fed applications. Many projects also require all moving axes to be above the work station, the F8800N provides that capability. Resolution is 1 micron and interpolation is in all axes. The F8800N has been engineered to accept a tool weight of up to 5kg and 2kg for the 4-axes model.

Dimensions

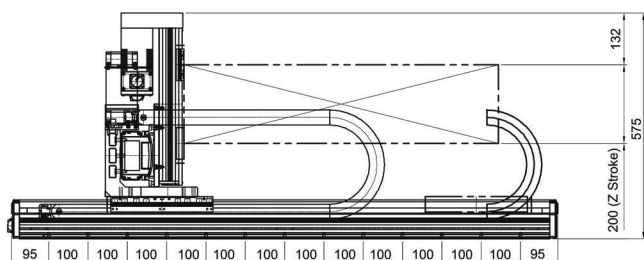
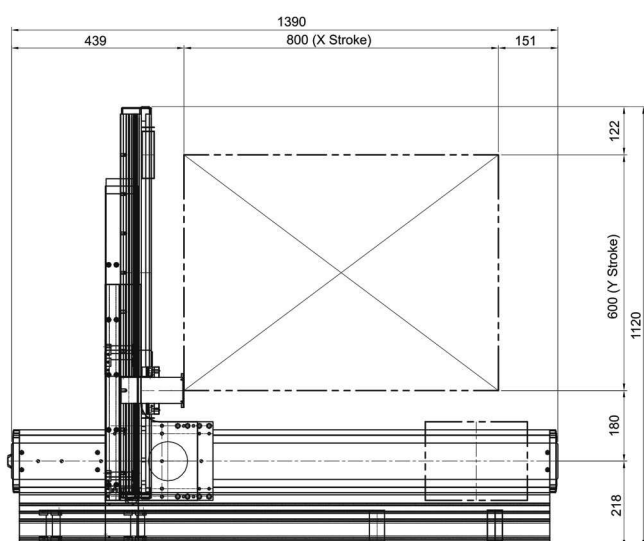

Model

F8800N

Robot 3-axes 220V

F8804N

Robot 4-axes 220V

Mounting Supports (optional)

Meaning
(three required)

| Main | Height | Qty |
|------------|--------|-----|
| 562024-050 | 50mm | 1 |
| 562024-100 | 100mm | 1 |
| 562024-150 | 150mm | 1 |

Specifications

| | | |
|-----------------------|---|-----------------|
| X/Y/Z Work area (mm): | 800 / 600 / 200 | R-axis +/-360° |
| Maximum Tool Load: | 5 kg. | R-axis 2 kg. |
| Body Frame X-axis: | 120mm - 200mm | |
| Body Frame Y-axis: | 90mm - 160mm | |
| Max. Speed X&Y / Z: | 1000 / 1000 / 500 (mm/sec) R-axis 360°/sec | |
| Repeatability: | +/- 0.02mm/ Axis | R-axis ± 0.058° |
| Resolution: | 0.001mm | R-axis ± 0.001° |
| Run Out Y-axis: | 0.1mm Full Travel | |
| Data Memory: | 100 Programs 20,000 step / 20,000 points | |
| Processor: | Main: 32bit, 900 mflops | |
| Servo Output X-axis: | 200 watt → 800 watt | |
| Servo Output Y-axis: | 200 watt → 400 watt | |
| Motion Control: | PTP & CP (3D Line, circle) | |
| Teaching Method: | Teach Pendant | |
| I/O Signals: | System I/O IN: 24, Out: 6 User I/O IN: 32, Out: 32 | |
| External Interface: | RS232 | |
| Power Supply: | 2Ø AC220V - 500VA (600VA) | |
| Dimensions (WxDxH): | 1110 x 1380 x 565 | |
| Weight: | 3-axes: 159 lbs (72 kg) 4-axes: 179 lbs (81 kg) | |

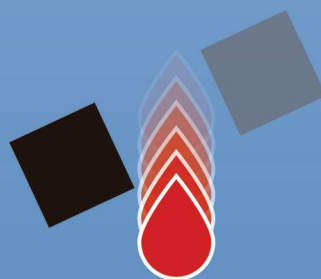

DOTEST, S.L.

Gran Via de Carles III, 33-35 bjs. - 08028 Barcelona

Tel. +34 93 490 55 60 - Fax +34 93 411 82 44

E-mail: jvacarisas@dotestsl.com

www.dotest.es